

# BOROUGHBRIDGE & DISTRICT HISTORICAL SOCIETY



## NEWSLETTER AUTUMN 2015

### CONTENTS

NOTES FROM THE CHAIRMAN	2
STUDLEY ROYAL	2-3
BERLIN WALL	4-5
BUILDINGS IN THE VALE OF YORK	6
SEWERBY HALL	7-8
DOG KENNEL LANE PROJECT	9-10
SOCIETY BUSINESS	11

### AUTUMN PROGRAMME

**TUESDAY, SEPTEMBER 8TH**

A NIGHT AT THE OPERA: THE DRESS, HAIR, LANGUAGE AND  
HABITS OF GEORGIAN THEATRE GOERS

TONY SMAILES

**TUESDAY, OCTOBER 13TH**

MEMBERS' EVENING

**TUESDAY, NOVEMBER 10TH**

THE BATTLE OF BOROUGHBRIDGE

LOUISE WHITTAKER

**TUESDAY, DECEMBER 8TH**

YORKSHIRE WOMEN AT WAR: THE STORY OF THE WOMEN'S  
LAND ARMY HOSTELS — MARION JEFFERIES

MEETINGS ARE HELD IN BOROUGHBRIDGE LIBRARY JUBILEE SUITE AT 7.30

ALL WELCOME; MEMBERS FREE



## NOTES FROM THE CHAIRMAN

J o h n W h i t e h o u s e

I hope members have enjoyed the summer break and recharged your batteries, so to speak, in terms of thinking up new initiatives that will take the Society forward during the next twelve months. The Dog Kennel Lane project has now effectively been concluded; David Barley's report on its achievements is set out below. All very impressive, but very few society members participated in this enterprise. Non-members predominated. Nevertheless the team is looking for a new project in which they hope Society members can become involved. To this end, as Linda's note explains, Kevin Cale has set out some parameters within which BDHS members could work on a project of their choice. A questionnaire will be circulated setting out the options and seeking further possible subjects. There is no compulsion to return this form if you are content with the status quo. In any case the necessary resources (time, personnel and financial) are currently rather scarce

and will need boosting in the event that a new venture is undertaken. Lottery funding may not be an option this time around.

The reorganisation of duties amongst committee members is working well thanks to the diligence of the members concerned. Their commitment deserves our gratitude. A quick "squint" at the guest speaker list for the next six months is very encouraging, including as it does a presentation on the Dog Kennel Lane project by Linda and David. So I look forward to your continuous support and perhaps, at the AGM in October, the opportunity to become more involved, say as a new committee member, may be seized by someone! Who knows..? In any event everybody is always welcome as without you we lose our *raison d'être*. There follows a very brief summary of the last three talks given as part of the spring and summer programme.

### Studley Royal

In April, Glenda Hunter described the 18th century wonder of the North, Studley Royal. We had a "walk-through" of the development of the park from its origin in the 16th century to the addition of Fountains Abbey and Fountains Hall in 1768 (acquired at a cost of £ 1m in today's money) to the occupation of the house by a Harrogate girls' school in World War 2. Fire destroyed the house in 1946 not long after the Marquis of Ripon had regained its occupancy. The National Trust and English Heritage took control of the whole site from NYCC in 1983 with the subsequent husbandry leading to the award of World Heritage Site status.

The River Skell flows through the park and provides the source of water for the ornate water features on site. The Aislaby family in the 18<sup>th</sup> century founded the deer herd, created the canal and cascade in 1713 and in 1760 opened the Chinese style gardens. The coffin lawn, Banqueting House and the octagonal temple of fame all originated about this time. A 19th century image of the Marquis of Ripon holding his favourite sporting/hunting gun interested me as the same weapon is displayed in a glass case at Newby Hall; obviously a valued heirloom.

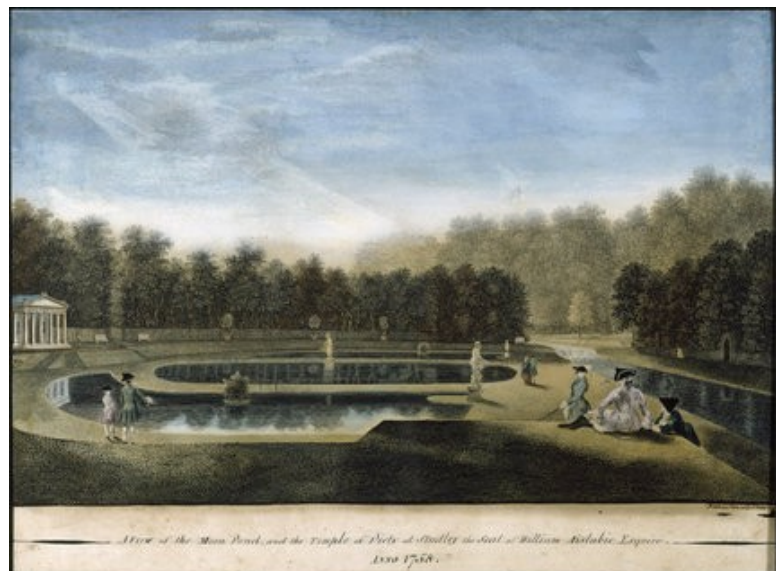

## Studley Royal Water Garden 'Then and Now'



## The Berlin Wall

May saw Tony Smailes give an account of the history of the Berlin Wall. Constructed some 16 years after the end of WW2 it stood for 28 years extending for 160kms from the Brandenburg Gate and finally closing thousands of kilometres of the border between east and west that had been fenced off since 1952, the so called Iron Curtain.

The events leading up to the erection of the wall can be dated as follows:

8/5/45	VE day - Berlin situated in the eastern or Russian zone of Germany was divided into British, French, American and Russian controlled zones.
1948	Berlin Airlift - Russians cut road, rail and canal routes between West Berlin and Western Germany thereby depriving the latter's population of food, fuel and supplies of every type. Utilities were switched off also. For seven months through the vicious winter of 1948/49 an airlift of 250 aircraft ferried food, clothing, medical supplies, fuel and every commodity to sustain life. The blockade-runners were so effective that the Russians eventually tired of the exercise and reopened the routes to the west.
1949-1989	Formation and development of the German Democratic Republic, senior partner of the Warsaw Pact with Russia.
1952	The Iron Curtain was erected across Europe between East and West.
1953	East Berlin uprising as passes to visit West Berlin were withdrawn and all movement out of East Berlin was criminalised.
1961	25% of the most able citizens of east Berlin (some 4 million) had fled to the west. A brain and skills drain that could not be endured. The Berlin wall was constructed to finally stem the flow.

### Some interesting statistics:

At the height of the Cold War some 10,000 espionage agents were thought to be active in Berlin on all sides.

GDR employed 40,000 border guards to seal their border with the West.

**West Berlin**

**East Berlin**

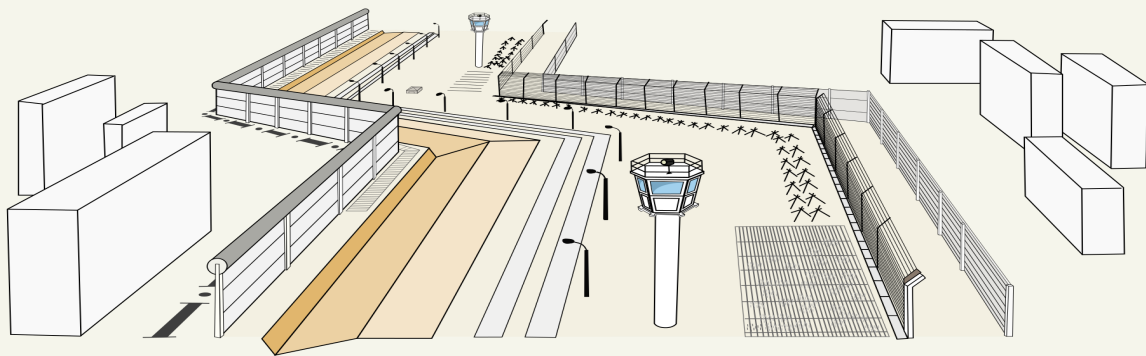





## The Berlin Wall

A Barrier Between East and West  
(above)

A Remnant of Cold War History (right)



## Buildings in the Vale of York

June gave us Barry Harrison and Vernacular Buildings in the Vale of York (1550-1750). Barry gave us an enthralling and well received listing of building methods applied to middle class properties in the Vale. York, Thirsk, Ripon and Yarm are apparently well served with these types of property.

Timber-framed, Sandstone/Limestone, Hip roof, Crutch roof, A framed roof, Dutch Gable, Brick build etc were all linked to examples of property using one or more of those methodologies. I will resist the compulsion to repeat the catalogue.

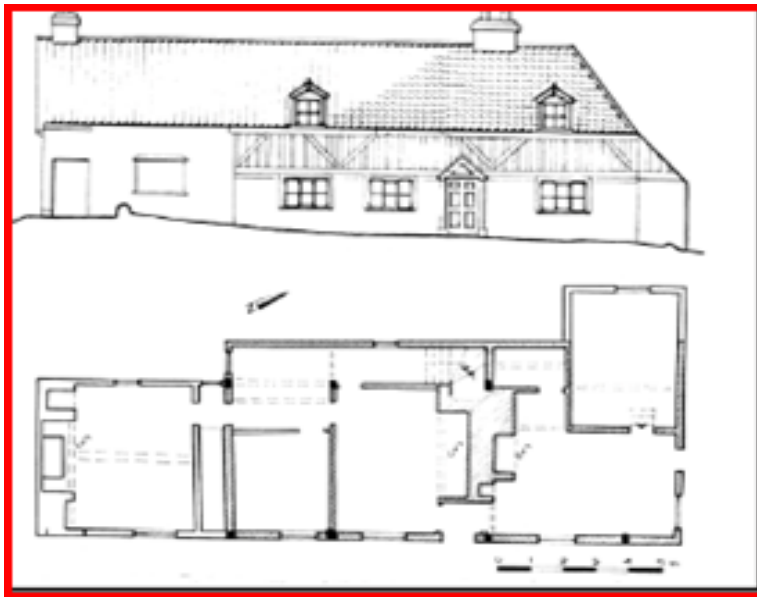

Ivy Farm, Crake Timber –framed lobby entrance house, early C17, extended in the C19



Timber framed buildings were common in the Vale of York and many have survived to this day

## **Sewerby Hall**

July's meeting was traditionally supplanted by a coach trip, this time to Sewerby Hall and Bridlington. Enjoyed by all and thanks are due to Margaret and Christine who organised this event.

As I type this, the thunder rolls and the rain pelts so I hope for some improvement soon. Wishing you all very good health.

John Whitehouse

## **Historical Society Annual Outing**

August 14<sup>th</sup> dawned fine for this year's outing which was to be to Bridlington & Sewerby Hall. On the day it was decided not to go to Bridlington after all as the coach park was a long way from the promenade. Instead we stopped for coffee at the Wolds Way Lavender Farm, where some members tested the lavender scones!

We soon arrived at Sewerby Hall, a fine Grade 1 listed mansion, constructed between 1714-1720 by the Greame family. Many additions were made between 1808 & 1856 including the orangery & stables (now being used as a cafe).

The Hall was closed in 2013 for a £2.6 million restoration.& reopened in 2014 completed to look as it would have been in 1910. Most rooms have interesting information as to how this was achieved, & are furnished with items from the Victoria & Albert Museum & other nationally important collections. The servants wing includes a working kitchen, butler's pantry & housekeeper's parlour.

Upstairs a set of rooms contain a permanent Amy Johnson exhibition & film, furnished bedrooms & an exhibition of 1900 costumes ,including some from "Downton Abbey"

Outside are 50 acres of landscaped gardens, including woodland walks & plenty of areas for a picnic. These areas were much enjoyed by some of us while a few went to the small Zoo. Here they found llamas ,pygmy goats, lemurs , monkeys & saw the penguins at feeding time.

We would like to thank all who joined the outing this year

Christine & Margaret Tasker





Images of Sewerby





## Dog Kennel Lane Project Update Summer 2015

We are now towards the end of our project, and our fortnightly study evenings have been spent finalising the Celebration Exhibition, the interpretation lectern, the leaflets and the information to be put on the website.



We have had three organised walks on the new "Dog Kennel Lane Circuit". The first, on Good Friday, was part of the Boroughbridge Walking Festival and was enjoyed by thirty members of the public. Unfortunately the weather was rather "iffy". The second was on the 1<sup>st</sup> May when years 3 and 4 from Skelton School walked from Langthorpe back to Skelton. This was led by Kevin and was to study the river and its effect on people through the ages. They also looked for wildlife and were told about Mary Ward and the ferry disaster of 1869.

The final walk was on Saturday May 23<sup>rd</sup>, and was part of our celebration weekend. This was led by Mike Collins and enjoyed by thirteen people, both project members and visitors.



Mike Collins leading the walk on the Celebration Weekend.

The main event was the Celebration Exhibition held on Sunday 24<sup>th</sup> May in the Coronation Hall. In spite of many people not being able to attend due to other commitments, about 60 people came along and all made favourable comments and were amazed at the amount of research we had done. After an introduction by David Barley the exhibition was opened by Peter Greenwood, Newby Hall Estates Manager, who unveiled a replica of the Interpretation Board for the Heritage Walk. Mr Greenwood mentioned that the Heritage Walk passes through grass fields with livestock, and that walkers should adhere to the Countryside Code.



David Barley, Linda Dooks, Peter Greenwood, and Kevin Cale at the opening of the Celebration Exhibition

Our Community Archaeologist, Kevin Cale, who was our guide throughout the project, gave a presentation with slides both in the morning and in the afternoon. This again was well received and showed: the background to the project; visits; talks; fieldwork; our involvement with Skelton Primary School; our findings; our research; and finally our outcomes. The centre of the Hall was occupied with display boards showing photographs and information of all the twenty eight topics we researched, from Aerial Photographs and Agriculture to Mary Ward and World War 2.

Along the far wall of the hall was a display cabinet containing a selection of our finds. These included worked flints; a George 3<sup>rd</sup> halfpenny; a World War 2 plastic Australian button; a flint from a flintlock gun and medieval pottery. Also in the cabinet were other artefacts from the area kindly lent by Alan Pearson and Geoff Harris which included flint arrowheads and a flint axe head. Also on display was a quern on loan from Harrogate B.C. Museums and Art.

Paul Follett and Kevin had a continuous visual display showing Lidar maps for the area. Lidar is digital imagery which shows the relief of the landscape. Also aerial photographs were on show from the 1940's to the 1990's. David Barley had an Oral History corner where visitors could listen to some of our recorded interviews. Also on display were photographs of old Boroughbridge and photographs of Boroughbridge in World War 2, all set up by Mike Tasker.

Since Easter we have had displays at two events: the first was on June 28<sup>th</sup> at Kirby Hill Church at their "Life in our village" exhibition; the second was on July 19<sup>th</sup> in the Craft Tent at Aldborough and Boroughbridge Show. We displayed a wider range of topics this year covering The Dog Kennel Lane Project, Boroughbridge in WW-2, and old photographs of Boroughbridge and the surrounding villages. We had a steady stream of interest both from local residents and visitors.

We erected the interpretation lectern on 20<sup>th</sup> July, and well it looks. Thanks to Gordon Sadler for doing the work FOC. We had the group photo-shoot taken around the lectern on Saturday 15<sup>th</sup> August.

More detailed reports of our events can be found on the home page of our website ([dogkennellane.co.uk](http://dogkennellane.co.uk)). Also on the website are reports of our findings under the drop down headings along the top turquoise bar.

Finally on behalf of the Historical Society I would like to give a special thanks to Mike Tasker for donating our new exhibition boards. These are easily assembled and transported, of excellent quality, and a great asset to the Society.

**David Barley**



The project group pictured around the new Dog Kennel Lane Circuit lectern

## **Society Business**

Firstly thank you to everyone for taking over the various jobs they have been allocated. The main contact for the group is now Margaret Tasker. In future my main job will be as archivist and it is hoped we can restart the Thursday afternoon research group.

We have had several family history enquiries from home and abroad. Dr. Hugh Stott has been in touch again asking if we have details of the sale of the Crown Hotel and Mynthurst to his family in 1834. He also wanted details about the Boroughbridge Agricultural Society which his family helped found. We were able to help with the first query because we have in our archive a marked up catalogue of the sale of the Boroughbridge estate by the Duke of Newcastle in 1834 donated by Ian To-pham.

Regarding the second query we referred him to Dr. Ron Nixon who has some records about the Agricultural Society. This is a separate venture to the Aldborough and Boroughbridge show and still holds meetings.

Isabella Clifford contacted the society via Deana the churchwarden at Cundall.

Isabella is researching her family including Rev. Thomas Horsefall and his son who was also a priest. Originally a curate at Kirby Hill, Thomas became the vicar at Cundall in the 1800s. His son was on his way out to India to do some missionary work when his ship was wrecked off Portugal. There is a memorial window in Cundall church to the family which depicts the shipwreck. A grandson of the family who went to Ripon Grammar school trained as a Master Mariner and explored a lot of the west coast of Canada. Naming the islands he discovered after the Horsfall family members, intriguingly a google maps search reveals them today. A cousin, another Thomas Horsefall, wrote the history of Well and Wath, north of Ripon. We have agreed to produce a little booklet about the family to be kept in the church.

## **Future Projects**

The Dog Kennel Lane members met in the middle of August to discuss what the group would like to do now the project had been completed.

It was felt that the group would like to work on other projects with a definite archaeological input in geophysics, field walking etc. An approach to one of the villages could be made to see if they were interested in this. A table top exercise such as researching the history of Boroughbridge was also discussed, using a timeline as a guide.

Kevin Cale who led our project was in attendance and advised us to look at three types of projects, town, village or landscape. The Dog Kennel Lane project was a landscape project. With this in mind at the September meeting we will be distributing a questionnaire so you may give us your ideas and support to any projects you think we should explore.

Thank You, **Linda Dooks**, Local History Coordinator and Archivist